



# Chi Tribune

President: Deanna IL-35-B Vice-President: Karen IL-3-M Secretary: Donna IL-11-S

Miss Donna Martin  
P.O. Box 218  
Markham, Ill. 60426

## CHI'S OCTOBER MEETING . . . . .

Since our Chapter President, Deanna, was not able to be with us during the evening, our meeting was conducted by our Vice-President, Karen. She opened the meeting by welcoming everyone, particularly our honored guest and National President, Carol Beecroft. Karen announced that the next Chapter social evening would be November 11th, at the Lite Factory; although this is not an "official" gathering, all Chapter members and our Chapter friends are invited to spend the evening together. Karen also reminded everyone that Christmas is approaching, and we would be receptive to an invitation from one of our members (who has a reasonably large home) to be our Hostess for the December meeting. Anyone who would care to volunteer please contact Deanna as soon as possible. Completing the business portion of the meeting, Karen asked each person present to rise and introduce themselves to our guest for the evening: Karen IL-3-M, Joan IL-6-C and Pat, Mitzi IL-8-C, Donna IL-11-S and Dee, Linda IL-16-S, Betty Ann IL-17-A, Elaine IL-22-A, Deanna IL-35-B, Kay IL-44-N, Denise IL-202-M, Mary Ann IL-203-B and Kathy, Mickey IL-204-S, Kiki IL-207-M, Susan IL-225-J, Marilee IL-300-S, Dee IL-301-N, Anne IL-304-G and Judy, Ruby IL-305-B and Elaine, Lynne IN-?-R, and Lois WI-13-V; Prospective members Jackie with Sue, Alicia with Sandy, and Dina. Upon completion of the introductions the meeting was turned over to Carol Beecroft for any remarks that she would care to make to the membership.

Carol told us she was most happy to be able to be with us again, and pleased to see the activity and growth of CHI Chapter. She advised that at the recent Tri-Ess Convention in San Francisco, the consensus was to return to New Orleans for the next convention in March of 1982. However, as in San Francisco, this time we will go "first class" in hotel, restaurants, and activities. Due to some last-minute problem and changes, the last Convention that was held in New Orleans was not of the best. However, that is not expected to happen again and Carol asked that everyone reserve late March of next year for the Convention, and plan to attend.

Carol indicated that the Femme Mirror is "next in line" for publication, and that she expected to maintain a regular bi-monthly schedule in the future for the national newsletter. Following the Femme Mirror, the membership Directory is scheduled to go to the printer in mid-November, with mailing shortly thereafter. Since a number of our members had expressed a concern about non-receipt of the Directory, we were asked whether we would like to have it completed ahead of the newsletter. After a brief discussion of the question a vote was taken, and a clear majority agreed with the original schedule of the newsletter first, then the Directory following.

Carol advised those present of changes that were being made in the organizational structure of Tri-Ess for over-all improvement, and the general reasons for them. (Since these matters will be formally announced in the next Femme Mirror, they will not be reported here). As with any group or organization, certain adjustments must be periodically made to keep us abreast of the changing times.

Although Carol did not mention it in her remarks, Donna raised a subject that has been discussed among individual members as well as at CHI meetings: Carol needs some help (of the secretarial type) since she is being "spread thin" with so many responsibilities. The point was made that our national dues have not been increased for many, many years even though inflation is taking its toll. Also, our Sorority is engaged in a national advertising program, has a need for our national Officers to regularly travel to organize and support our Chapters,

(Continued)

(Cont.)

and has other expenses not even thought about when our current dues structure was established. The members present were asked if they would support a reasonable annual dues increase to help off-set inflation (everything else is going up; gasoline is no longer 35¢ a gallon), possibly help to secure some part-time office assistance, and allow greater organizational efforts. Since no one in the Sorority receives any remuneration (except a \$100.00/month travel allowance recently granted to Carol for her work with Chapters), and in fact many expenses are paid for by our Leaders "out-of-pocket," any increase in annual dues will be used 100% for the work of the Sorority. Based upon these facts, CHI Chapter went on record as strongly supporting a reasonable increase in the annual dues for Tri-Ess.

Our thanks to Carol for being able to be with us. We benefited from her general comments, and we trust that she received input from the comments of our membership both during the formal Chapter meeting, and during the social period afterwards.

CHI TREASURER'S REPORT . . . . .

Balance on hand, September 30th:	\$ 85.61
Meeting Fee:	+161.00
Regular Member Dues ( $\frac{1}{2}$ year):	+ 3.00
Regular Member Dues (1982):	+ 18.00
Associate Member Dues (1982):	+ 4.00
Donations:	+ 10.00
Miscellaneous:	+ 32.00
Withdrawal from Reserve Fund:	+200.00
Reserve Fund Interest:	+ 10.45
Meeting Room:	-188.80
*Refreshments:	- 17.00
Postage:	- 26.94
Supplies (Envelopes):	- 2.60
Miscellaneous:	- 7.00
Chapter Reserve Fund:	<u>- 10.45</u>
Balance on hand, October 31st:	\$271.27

\*Many thanks to Karen and Deanna, for their very kind donations which off-set the cost of our refreshments this month. They were most appreciated!

ABOUT THAT ZIP+4 . . . . .

Some of our members who have been assigned the new "ZIP+4" nine-digit numbers have been submitting changes of address to the Chapter reflecting the four-digit addition to their present ZIP code. Congress has delayed implementation of the program until October, 1983. Thus, CHI Chapter will not be using the new ZIP codes on our mailing list until such time as the final details of the program are worked out and approved by Congress. At that time we will request address corrections from all of our members, and begin using the new ZIP code system. Until then, you will continue to receive the newsletter bearing your present five-digit ZIP code.

R.I.P. . . . .

As reported in the October newsletter, the "Great Lakes Edition" of the CHI Tribune was in poor health because of the practical problems of reproducing the newsletter in the quantities required due to the anticipated sale of your Editor's company, with loss of Xeroxing availability. Since then, the company has indeed been sold and a limitation has been placed on employee use of the company Xerox machine. For this reason, as well as the overall changes to be made in the national organization, distribution of the CHI Tribune to the general Great Lakes Area has been terminated. All Regular and Associate members of CHI Chapter will continue to receive this newsletter as before, and a new newsletter (on a national basis) is in the planning stages as a replacement for those who are not in association with a local Chapter. Although your Editor may shed a few tears over the demise of a four year effort in attempting a continuity of communication among the Great Lakes Area membership (which, incidentally, was maintained at personal and not CHI Chapter expense), I look forward to bigger and better things in the future. Nothing is permanent, as witnessed by both the lament and hope, "The King is dead, long live the King!" So, although the Area edition is now dead (Rest in Peace), something better is in development for our Area members and they will not be forgotten.

DATES, DATES, DATES . . . . .

One of our members recently suggested that the Chapter schedule its meetings so that they don't conflict with the Tri-Ess Convention, Fantasia Fair, etc. While we do our utmost to avoid conflicts with major activities of our own and similar organizations, as well as the major Holidays, it must be remembered that there are only a limited number of Saturdays (the day of the week preferred by the majority of the Chapter), and we must be governed accordingly. Also, it must be remembered that most of our members are not able to attend distant activities and our Chapter meetings must remain available to our "stay at homes." With this in mind, we will continue to attempt to schedule our Chapter meeting dates to avoid "conflicts" wherever possible. We thank our Chapter Sister for her suggestion, and we will do our best to accommodate in the future.

CHI'S NOVEMBER MEETING . . . . .

The next meeting of CHI Chapter will be held on the third Saturday of this month, November 21st. Regular members and invited guests please promptly return the post card enclosed with this newsletter; Associate members who plan to attend the November meeting please telephone your Hostess so we will know to expect you. Information on the meeting location and time will be found on a separate sheet.

As a special program, we expect to have Sue with us presenting a lingerie demonstration. Although your Editor is familiar with various "party" plans (Tupperware, cosmetics, jewelry, etc), this was the first time she had heard of a "Lingerie" party! Sue advised that she, with the assistance of prospective member Jackie, will model the various items available. The program will last approximately one hour, and to accommodate Sue's schedule will begin promptly at 8:30 P.M. with our formal Chapter meeting following. All items shown will be available for ordering, either for personal use or as a Christmas gift for that "special" person in your life. The highest priced item in Sue's line is \$45.00, with most priced in the \$20.00 range; there is, of course, no obligation to purchase, and Sue will be available after the demonstration for individual consultation. Plan now to attend this month's meeting, for something new and different. See you there?



*Donna*

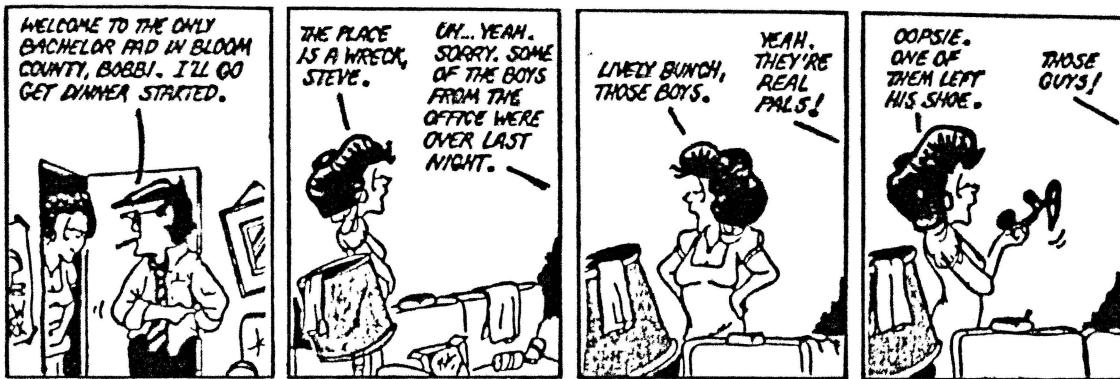

PATRONIZE OUR CHAPTER FRIENDS —

Monthly Social \* **LITE FACTORY** DISCO  
2500 N. SOUTHPORT, CHICAGO, ILL. 60614

  
**Undercover Wear Inc.**  
SUE STORM  
(Lingerie Demonstrations)  
(312) 420-1334

Our November 21st meeting is scheduled for the Midway Motor Lodge, 1600 Oakton Street, Elk Grove Village. The motel is located just northwest of the intersection of Route 83 (Oakton Street) and Route 72 (Higgins Road), just a few miles northwest of O'Hare Airport. We have reserved a Suite (Rooms 160/162/164), on the first floor with access through the entrance marked number "6" on the northwest side of the motel complex. (Alternate Suite will be Rooms 166/168/170). Our rooms will be open after 3:00 P.M. for the convenience of our members who are traveling long distances, with the usual sign on the room door for identification. Although adequate changing rooms will be available in our Suite, any member who wishes to reserve their own room should make arrangements directly with the Motel; tell them that you are with the Tri-Ess group, and you will be given a room as close to the meeting Suite as possible.

If you have a last minute problem, or change of plans, please telephone Deanna (Dave) at (312) 455-3709, or call the motel and ask for the "Tri-Ess Room." If you received a post card with this newsletter, please fill it out and return it promptly so that we can make the necessary arrangements for the anticipated attendance; Associate Members please telephone the above number in advance, for the same reason, if you plan on attending.

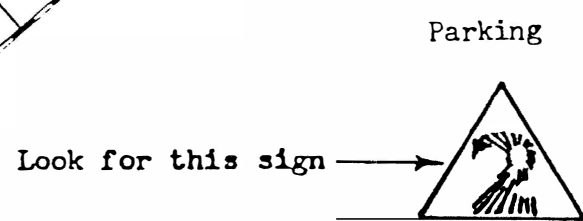
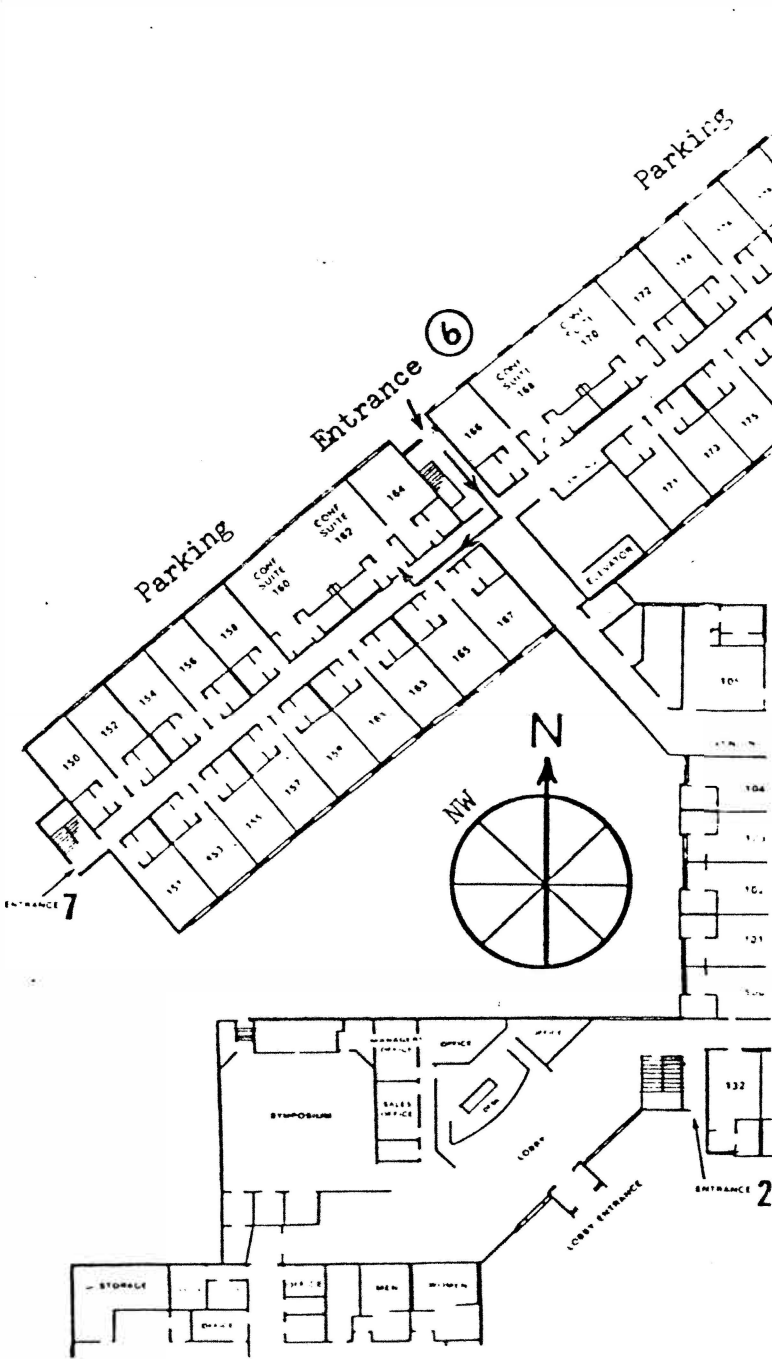

# Midway Motor Lodge

 1600 OAKTON STREET  
ELK GROVE, ILLINOIS 60007  
(312) 981-0010

